

Dimension: (UNIT:mm)

A	16.9 ± 0.4
B	7.6 ± 0.2
C	5.5 ± 0.2
D	5.6 ± 0.15
E	13.2 ± 0.34
F	7.3 ± 0.15
G	2.9 ± 0.2
H	

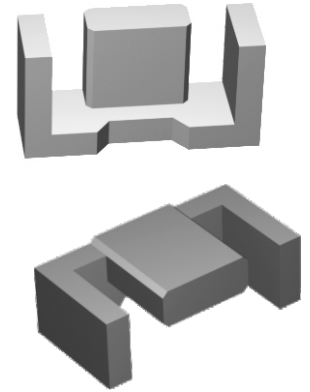
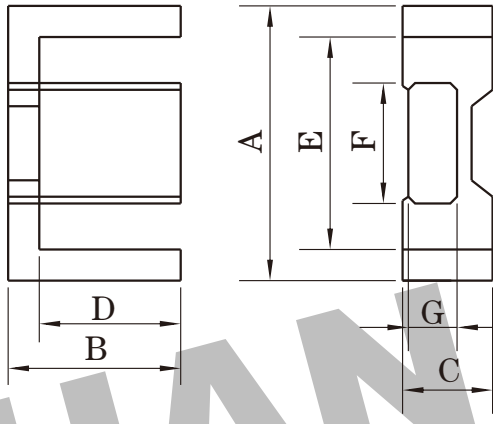

Test conditions

AL: F=1.0KHz U=0.3V N=10Ts

Effective parameter

C1(mm) ⁻¹	Ae(mm ²)	Le(mm)	Ve(mm ³)	Weight(g)
1.77	20	35.4	780	≈1.6

Core sets

Clamping force for AI measurements, 20+/-10N

Grade	AL (nH)	μe	AIR GAP μm	Type number
P3	1400 ± 25%	≈ 1680	≈ 0	EFD17-P3
P4	1400 ± 25%	≈ 1680	≈ 0	EFD17-P4
HQ2KA	1310 ± 25%	≈ 1600	≈ 0	EFD17-HQ2KA
HQ2K	1310 ± 25%	≈ 1600	≈ 0	EFD17-HQ2K
P5	1050 ± 25%	≈ 1050	≈ 0	EFD17-P5

Core sets of high permeability grades.

Clamping force for AI measurements, 20+/-10N

Grade	AL (nH)	μe	AIR GAP μm	Type number
H5K	3800+40/-30%	≈ 6800	≈ 0	EFD17-H5K

Properties of core sets under power conditions

Grade	B (mT) at H=250 A/m F=25KHz T=100°C	Core loss (w) at			
		F=100 KHz B=100mT T=100°C	f=100 KHz B=200mT T=100°C	F=400 KHz B=50mT T=100°C	F=500 KHz B=50mT T=100°C
P3	≥ 320	≤ 0.057	-	-	-
P4	≥ 320	≤ 0.045	≤ 0.28	-	-
HQ2KA	≥ 340	≤ 0.035	≤ 0.22	≤ 0.09	≤ 0.19
HQ2K	≥ 315	≤ 0.06	-	≤ 0.1	-
P5	≥ 300	-	-	≤ 0.05	≤ 0.06

Properties of core sets under power conditions (continued)

Grade	B (mT) at H=250 A/m F=25KHz T=100°C	Core loss (w) at			
		F=500 KHz B=100mT T=100°C	F=1.0 Mhz B=30mT T=100°C	F=1.0MHz B=50mT T=100°C	F=3.0MHz B=10mT T=100°C
P3	≥ 320	-	-	-	-
P4	≥ 320	-	-	-	-
HQ2KA	≥ 340	-	-	-	-
HQ2K	≥ 315	-	-	-	-
P5	≥ 300	≤ 0.5	-	-	-

Note:

- 1: Document is the property of FUAN Inc & is not allow to be duplicated without authorization
- 2: RoHS compliant.